

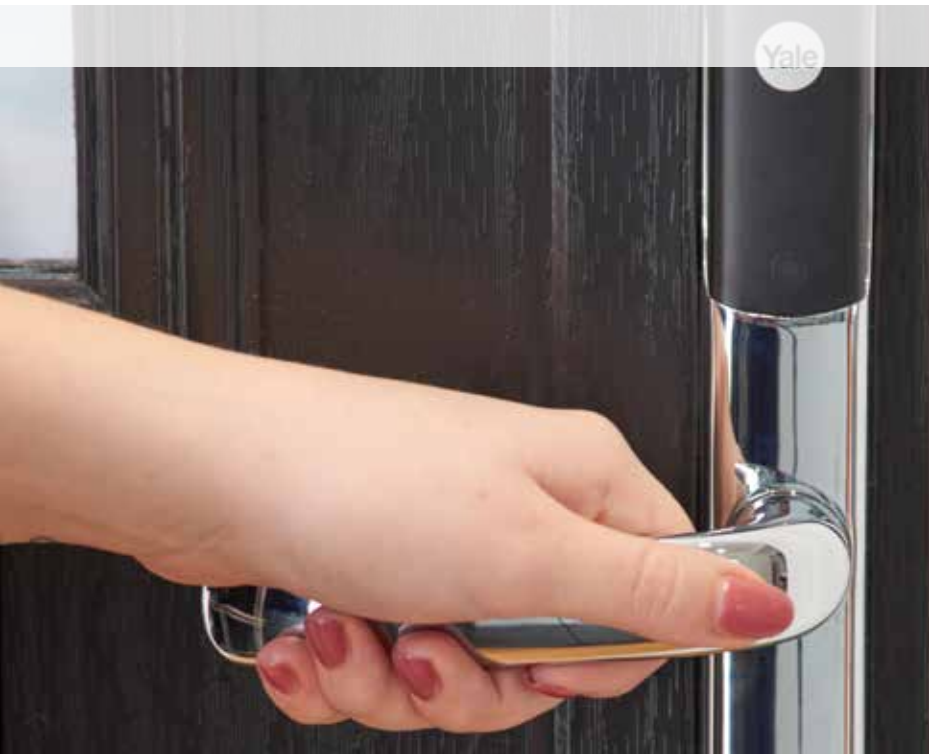

Yale Smart Living User Installation Guide



Contents

Introduction	3
Conexis™ L1 Smart Door Lock	4
User Requirements	4
Getting to Know Your Conexis™ L1 Smart Door Lock	5
What Has Been Installed?	6
Select Your Preferred Opening Method	6
What You Need to Do: Step by Step Guide	7
Using Your Conexis™ L1 Smart Door Lock with Smart Phone App and Key Tags	12
Using Your Conexis™ L1 Smart Door Lock with Key Tags ONLY	16
Registering Additional Key Tags	16
Unlocking the Door with Key Tag	20
Unlocking the Door with Mobile Key	21
Locking the Door	23
Sending a Mobile Key	24
Digital Door Viewer	28
What Has Been Installed?	28
Getting to Know Your DDV	29
What You Need to Do - Step by Step Guide	30
Using Your DDV	34
Ongoing Support	37

Introduction



This guide provides you with step by step instructions on how to use your new Yale Smart Living products.

The range comprises the Yale Conexis™ L1 Smart Door Lock which provides the freedom to secure homes without the need for a conventional key. The range also includes a Digital Door Viewer (DDV) providing a safe way to identify visitors.

Simply navigate to the section for your purchased product, or products, and follow the step by step instructions.



Conexis™ L1 Smart Door Lock.



Digital Door Viewer.

Conexis™ L1 Smart Door Lock



The Conexis™ L1 Smart Door Lock provides the freedom to secure homes without the need for a conventional key.

They are simple to use and provide complete control in unlocking your door.

The door can be opened through the use of Key Tags, or a Smart Phone.

Simply follow the steps outlined and your Conexis™ L1 Smart Door Lock will be fully functional and ready to go.

User Requirements

Your sales representative will have discussed the user requirements with you during their initial visit. It is important that you meet these requirements so that you can make full use of the Conexis™ L1 Smart Door Lock.

- A Smart Phone with iOS 9.0 or higher OR Android 4.3 or higher. *(Available on Apple and Android Platforms only).*
- A Smart Phone with an active SIM, for ability to send encrypted keys.
- A Smart Phone with Bluetooth capability.
- Download of the Yale Smart Living Lock App onto Smart Phone.

If you don't have the Yale Smart Living Lock application just yet, don't worry as this is carried out in the step by step procedure.

Getting to know your Conexis™ L1 Smart Door Lock

Inside

Radio Cover

Inside Light

Lever Handle

Thumbturn

Battery Cover



Outside

Tag Reader

Bluetooth Wakeup
Button and Light

Lever Handle

Backup 9V
Battery Contacts



What has been installed?

Your installation team will have carried out the following whilst installing the product in your home.

1. Fitting of the Conexis™ L1 Smart Door Lock
2. Set Up the Key Tags

Your Conexis™ L1 Smart Door Lock will have come with three Key Tags, and any additional Key Tags you have purchased. Your installation team will have set all these up for you so that the Conexis™ L1 Smart Door Lock is ready to use should you not have time to carry out the full Smart Phone set up right now.

Select Your Preferred Opening Method

It is important that you select your preferred opening method or methods, as it will dictate the set up process. Consider whether you will use your Conexis™ L1 Smart Door Lock with:

- Smart Phone App and Key Tag (Recommended)

OR

- Key Tags Only

Once you've decided how you will use the handle follow the relevant installation route.

What you need to do: step by step guide

1

Using your Conexis™ L1 Smart Door Lock with Smart Phone App and Key Tags

On your Smart Phone navigate to your app store.

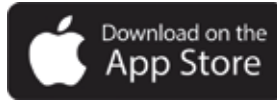

IOS 9.0 onwards



Android 4.3 onwards

2

Search for "Conexis L1".



3

Download the Yale Smart Living Lock app



4

Open the Yale Smart Living Lock app on your Smart Phone.



What you need to do: step by step guide

5

Click "Not Signed Up Yet?".



The image shows the Yale login interface. At the top is the Yale logo. Below it are input fields for "Email" and "Password". There are two links: "Forgot password?" and "Not signed up yet?". At the bottom is a yellow button labeled "LOGIN".

6

Register yourself through completion of the User Registration form.



The image shows the "User Registration" form. It has a back arrow and the title "User Registration". The form contains input fields for "First Name", "Last Name", "Email", "Password", and "Confirm Password". Below these fields is a section titled "Security Questions" with the question "What was the last name of your favorite teacher?".

What you need to do: step by step guide

7

Create a Mobile Key

Please ensure that Bluetooth is turned on, on your Smart Phone.

Within the App press, "Add New Lock".

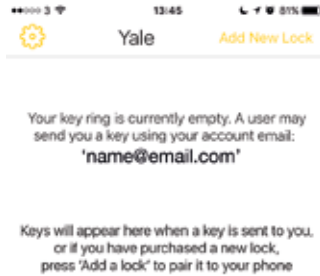

8

Choose a name for your Key/Lock. (e.g. Front Door), then press "OK".



What you need to do: step by step guide

9

When prompted by App please complete the following steps. On the interior handle lift up and off the upper casing.



10

Press the "R" button to make the Conexis™ L1 Smart Door Lock enter "Learn" mode.



The exterior handle will show a purple Light.



What you need to do: step by step guide

11

Press the purple light button to wake up the Bluetooth.



The light will turn blue.



12

Place your phone next to the reader on the external handle.



What you need to do: step by step guide

13

The Mobile Key will now be registered.



Using your Conexis™ L1 Smart Door Lock with Smart Phone App and Key Tags

Now that you've got your app all set up and ready to go, it's time to re-register your Key Tags. *(Ensure you have all your Key Tags available).*

1

Open the Yale Smart Living Lock app on your Smart Phone.



What you need to do: step by step guide

2

Navigate to the lock menu by clicking the lock icon, then select "Cards/Tag".

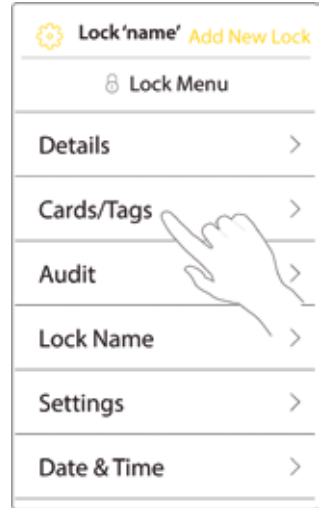

3

Select "New Card/Tag" at the bottom of the screen.



What you need to do: step by step guide

4

Enter a name for the Smart Key Tag.
(e.g. Joe Bloggs' Key)

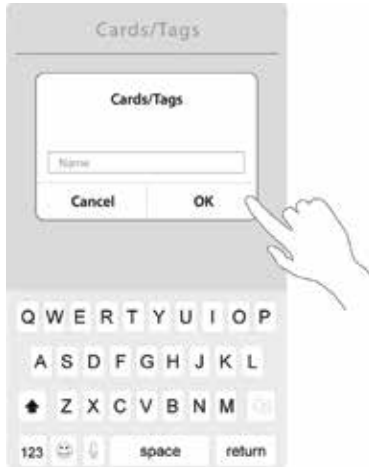

5

Press the Bluetooth wakeup button on the exterior handle when prompted by App.



The light will turn from blue to purple.



What you need to do: step by step guide

6

When the light turns purple hold the relevant Key Tag up to the Key Tag reader.

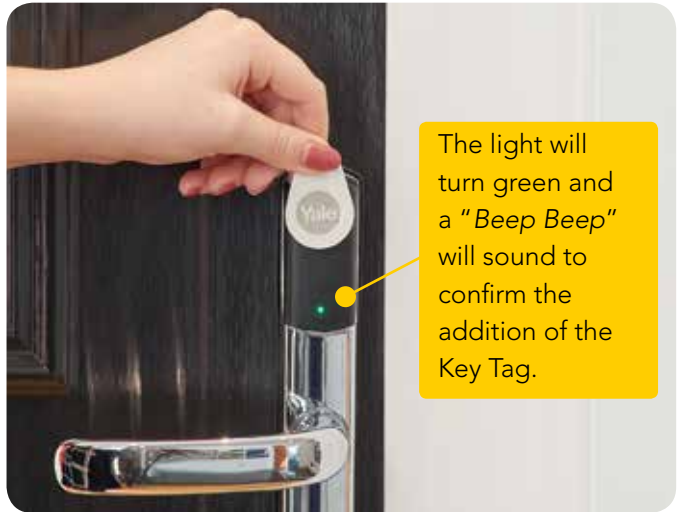

7

The registered Key Tag will now appear within the App.

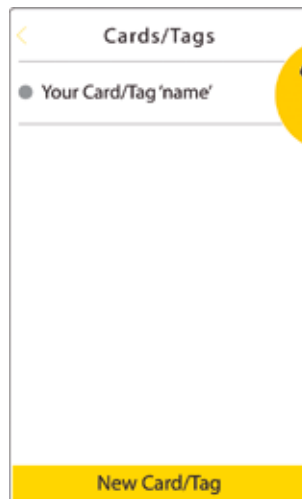

Repeat this process for all remaining Key Tags.

What you need to do: step by step guide

PLEASE NOTE

Steps 1-11 are only applicable when using the key tags only, these steps are not applicable when paired with the Conexis App.

Using Your Conexis™ L1 Smart Door Lock with Key Tags ONLY

As you've opted to use Key Tags only, there's no need to install the Smart Phone App.

You can always change your mind at a later date, however the key tag registration process will need to be repeated.

Registering Additional Key Tags

Your installation team will have set up your Key Tags at point of installation, however if you have purchased more you will need to register all your Key Tags with the Conexis™ L1 Smart Door Lock again.

Additional Key Tags are available for purchase* should you misplace your existing Key Tags or just need more. This can be done through our Contact Centre who can be contacted on **0800 988 9398**.

1

On the interior handle lift up and off the upper casing.



**Purchase of additional key tags will require the entire key tag registration process to be repeated for new and existing key tags.*

What you need to do: step by step guide

2

Press the "R" button to make the Conexis™ L1 Smart Door Lock enter "Learn" Mode.



Adding Tags in this way will delete any existing Tags.

3

Present the Key Tag to the Key Tag Reader on the external handle.

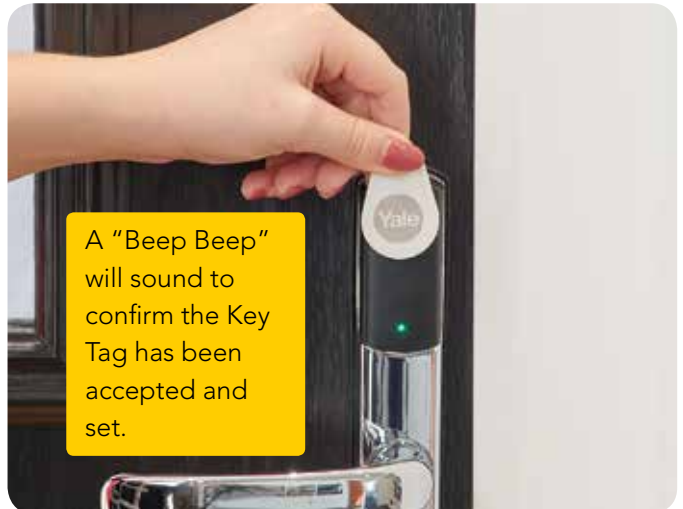

4

What you need to do: step by step guide

5

Hold the next Key Tag up to the Key Tag Reader, again a “Beep Beep” will sound to confirm the Key Tag has been accepted and set.

Do this again for each of the Key Tags you have.

6

Once you have repeated the above for all your Key Tags, press the “R” button on the internal handle to exit the learn mode.

PLEASE NOTE

Steps 1-11 are only applicable when using the key tags only, these steps are not applicable when paired with the Conexis App.



7

Re-attach the upper casing to the interior handle.

8

To test the Key Tags, exit the property (ensuring you have an alternative access point to your home should the Key Tags not have paired successfully).

What you need to do: step by step guide

9

Close and Lock the Door.

10

Present the Key Tag to the Key Tag Reader and confirm if the door has been unlocked.

11

Repeat for all key tags.

If for any reason that a Key Tag hasn't been registered accordingly, please repeat the steps from step 1 onwards.

If a Key Tag repeatedly fails to register, please get in contact. Details can be found in the ongoing support section.

What you need to do: step by step guide

1

Unlocking the Door with Key Tag

Present Key Tag within a few millimetres of the Key Tag Reader.



2

Push down lever handle to open door.



What you need to do: step by step guide

1

Unlocking the Door with Mobile Key

Ensure that Bluetooth is turned on, on your Smart Phone and that the Yale Conexis App is running in the background of your phone. If you have closed the App fully simply open and select the mobile key you previously set up.



2

Press the Bluetooth Wake Up button on the exterior handle.



What you need to do: step by step guide

3

Present your smart phone to the Conexis™ L1 Smart Door Lock, turn your smart phone 90 degrees clockwise, and then turn back 90 degrees to vertical position.



4

Push down lever handle to open door.



What you need to do: step by step guide

1

Locking the Door

Close the door.

2

Lift the handle fully up. The lock will engage and confirm by three beeps, followed by a pause and then a further three beeps.



3

Check the door is locked, by pressing down on the lever handle.

This process is the same for both the internal and external handle.



What you need to do: step by step guide

Sending a Mobile Key

Only the key owner/administrator can send a temporary or permanent key to family and friends through the Conexis App. Before you send the key they need to download the App in order to use the mobile key.

1

Open the Conexis App on your Smart Phone.



2

Navigate to the lock menu by clicking the lock icon, then select "Manage Users".

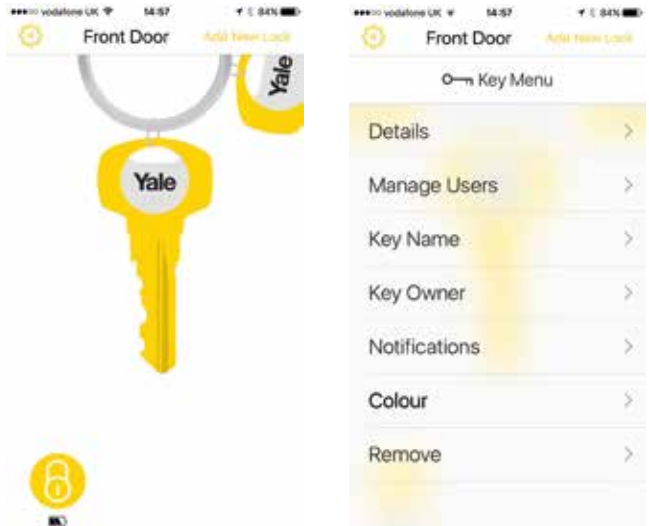

What you need to do: step by step guide

3

Click on "Invite user to access these locks".

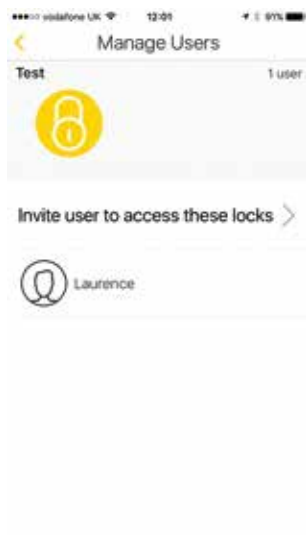

4

Enter the contact name or email address of the person you wish to send a key to and enter.

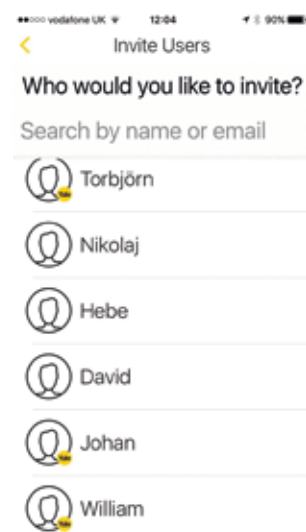

What you need to do: step by step guide

5

Confirm if you would like to schedule a key or send a permanent key for the person.

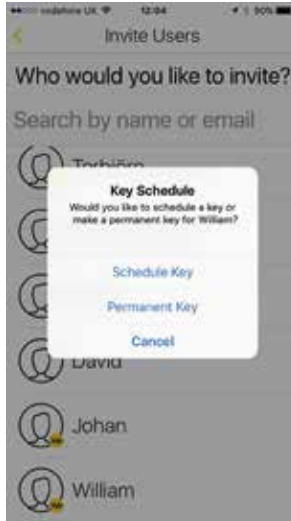

6

If creating a temporary mobile key, select the times and dates you wish to have the key scheduled for, then click "Issue Key".



What you need to do: step by step guide

7

Verify password to share this key.



8

The person receiving the mobile key must tap on the key to accept it.

Digital Door Viewer

Digital Door Viewers (DDV) display an image of a person visiting a property, providing a safe way to identify visitors and potential bogus callers before opening a door.



The Yale DDV can also store up to 50 images on its optional internal memory whilst you are away from home, with time and date stamps. A Micro SD card (not included), can be installed to add further memory.

In built night vision functionality also ensures you get a clear image whether it's day or night.

What Has Been Installed

Your installation team would have fitted the Digital Door Viewer to your new Anglian door.

Digital Door Viewer

Getting to Know Your DDV

Night Vision

Camera

Door Bell



Menu Button

Battery Compartment

Power Button

4 inch LCD Screen

Door Bell Speaker



What you need to do: step by step guide

1

Setting up Your DDV

Please ensure you have the current time and date handy for this process.

Slide open the battery compartment and insert the batteries provided paying close attention to the format shown on the inside of the battery compartment cover.



2

Press the power button, then press the menu button.



What you need to do: step by step guide

3

Select the relevant hour (24hrs) by using the arrow buttons to go up or down as appropriate. Press the menu button to set the hour.

The minute will begin flashing.

4

Select the relevant minute by using the arrow buttons to go up or down as appropriate. Press the menu button to set the minute.

5

Select the relevant second by using the arrow buttons to go up or down as appropriate. Press the menu button to set the second.

The bell and tune icons will now begin flashing.

6

Select the doorbell tune you wish, using the arrow buttons to cycle through the available doorbell tunes. Once you have found the tune you want, press the menu button to set it.

The volume icon will begin flashing.

What you need to do: step by step guide

7

Select the volume of the doorbell you wish, using the arrow buttons to increase or decrease the volume as appropriate. Once you are happy with the volume, press the menu button to set it.

The settings and screen power time will now begin flashing.

8

Select how long you would like the screen to stay powered for by using the arrow buttons to increase or decrease the time as appropriate. (10s, 15s or 20s) Once happy with the selection press the menu button to set.

(Note longer period of time will cause the battery life to deteriorate quicker).

The memory location will now begin flashing.

9

Select the memory storage by using the arrows, the options are the DDV device or a micro SD card (if you have installed one), these are indicated by relatable icons. Press the menu button to set this.

You will now return to the time and date screen.

What you need to do: step by step guide

10

Reset the time if appropriate.

11

Leave the DDV, and the external image will appear.

Your DDV setup is now complete.

What you need to do: step by step guide

1

Using Your DDV

Visitors to Your Home

When a visitor comes to your home they will press the doorbell.

2

The doorbell tune you have selected will then sound, and the DDV screen will power up for the length of time you selected. A photo of the visitor will also be taken and stored, provided there is available memory.



3

If the DDV screen has powered down before you have reached the door, simply press the power button to wake the screen up again.

What you need to do: step by step guide

Reviewing the DDV Photo Album

A photo will be taken of a visitor each time they ring the door bell, with a date and time stamp so you can view who has visited your property whilst you have been away.

The DDV has an internal memory capable of storing 50 images, there is an additional Micro SD card memory slot on the back of the DDV should you wish to increase the storage capacity.

1

Turn the DDV on by pressing the power button.

2

Press the Up arrow to enter the DDV album.

3

Use the Up and Down arrows to scroll through the photos within the album.

What you need to do: step by step guide

Managing the DDV Photo Album

In order to conserve memory and ensure there is enough storage for future photos of visitors, it's important that you manage the DDV album by deleting photos that are no longer required.

1

Turn the DDV on by pressing the power button.

2

Press the Up arrow to enter the DDV album.

3

Use the Up and Down arrows to scroll through the photos within the album.

4

When on a picture you wish to remove, press the menu button.

5

A picture of a recycle bin will appear. Press the down arrow to confirm you wish to delete the photo.

General Enquiry

Should you have a general query regarding the set up and operation of your new Smart Living product or if you feel like something isn't working correctly with your product, please contact the friendly Yale Helpline on 01902 364606 or email info@yale.co.uk.

The Yale helpline is open from Monday to Friday from 8:30am to 5:30pm.

Out of Hours

In case of emergency such as being unable to access your property, we will be on hand to help, contact the emergency line on 0800 078 7022. The emergency line is open 24 hours, seven days a week.

Ordering Additional Smart Key Tags

The contact centre can be contacted on 0800 988 9398, the call centre is open from 8:45am to 9:00pm (Monday to Friday) and 9:00am to 5:00pm (Saturday and Sunday), excluding Bank Holidays.



Registered office: Anglian Windows Limited, Liberator Road,
Norwich NR6 6EU. Registered in England No. 2540020.
Anglian Home Improvements is a trading name of Anglian Windows Limited.

www.anglianhome.co.uk

Anglian Home Improvements policy is one of continued development and in accordance with this, we reserve the right to amend specification of our products as their development dictates.

The Conexis™ name is the property of Assa Abloy Ltd.